

### Proposed Key Plan

Scale 1:5000 @ A3



| Rev | Sis | Description        | Date     |
|-----|-----|--------------------|----------|
| P01 | S2  | Issue For Planning | 15.06.22 |
|     |     |                    |          |
|     |     |                    |          |
|     |     |                    |          |

**MMOS**  
 The Chapel,  
 Blackrock House,  
 Blackrock, Co. Dublin, T12 XBR7  
 MURPHY · MANTON · O'SULLIVAN  
 CONSULTING CIVIL & STRUCTURAL ENGINEERS  
 TEL : 353 21 4317808

PROJECT  
 Jacobs Island - SHD

CLIENT  
 Hibernia Star Ltd.

TITLE  
 Proposed Auto Tracking - Car

DRAWN BY  
 D.B.

CHECKED BY  
 B.L.

APPROVED BY  
 M.M.

SCALE  
 As Shown

PROJECT NUMBER  
 21168

DOCUMENT REFERENCE  
 21168-MMS-ZZ-ST-DR-C-10211

STATUS  
 S2

PROJECT ORIGINATOR/ZONE/LEVEL/TYPE/DCP/LINE NUMBER  
 P01

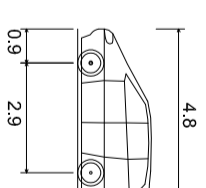

- Standard Design Vehicle (SDV)
- Overall Length 4.800m
  - Overall Width 2.000m
  - Overall Body Height 1.950m
  - Min Body Ground Clearance 0.100m
  - Track Width 2.000m
  - Lock-to-lock time 4.00s
  - Wall to Wall Turning Radius 6.000m

- Legend:
- Denotes Front Type Path
  - Denotes Front of Vehicle
  - Body Path

# Proposed Auto Tracking - Car

Scale 1:500 @ A3

