

Proposed Key Plan

Scale 1:5000 @ A3



Rev	Sis	Description	Date
P01	S2	Issue For Planning	15.06.22

MMOS
 The Chapel,
 Blackrock House,
 Blackrock, Co. Dublin, T12 X8K7
 MURPHY · MANTON · O'SULLIVAN
 CONSULTING CIVIL & STRUCTURAL ENGINEERS
 TEL : 353 21 4317808

PROJECT
 Jacobs Island - SHD

CLIENT
 Hibernia Star Ltd.

TITLE
 Proposed Auto Tracking - Car

DRAWN BY: D.B. CHECKED BY: B.L. APPROVED BY: M.M.
 SCALE: As Shown PROJECT NUMBER: 21168

DOCUMENT REFERENCE
 21168-MMS-ZZ-ST-DR-C-10212
 PROJECT-ORIGINATOR-ZONE-LEVEL-TYPE-CD-PRJ-NO. STATUS: P01 S2

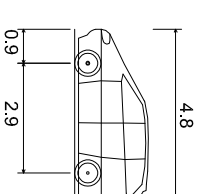

- Standard Design Vehicle (SDV)
- Overall Length 4.800m
 - Overall Width 2.000m
 - Overall Body Height 1.950m
 - Min Body Ground Clearance 0.100m
 - Track Width 2.000m
 - Lock-to-lock time 4.00s
 - Wall to Wall Turning Radius 6.000m

- Legend:
- Denotes Front Type Path
 - Denotes Front of Vehicle
 - Body Path

Proposed Auto Tracking - Car

Scale 1:500 @ A3

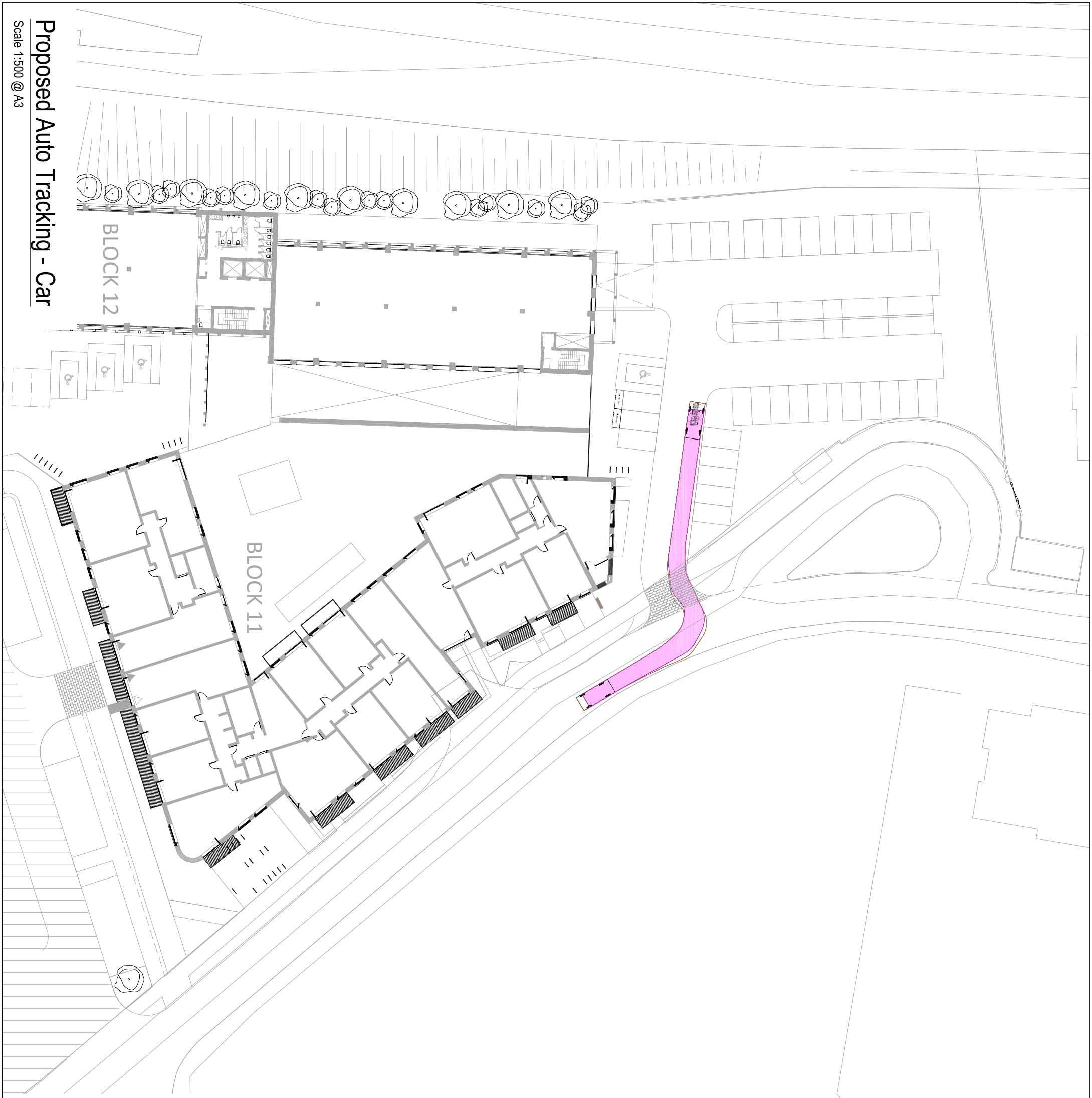

BLOCK 12

BLOCK 11